



enertech
COLLECTION



panorama

TRIPLE-GLAZED CASEMENT & AWNING WINDOW

FEATURES:

- Contemporary design** with squared off frame and sash
- Sash leveled with frame** for more balanced appearance
- 4" frame depth** with better thermal performance
- 30% less frame** and more glass than standard casement or awning windows



WEST COAST
WINDOWS™
— EST 1976 —

DESIGNED FOR LIFE™



panorama

TRIPLE-GLAZED
CASEMENT &
AWNING WINDOW

Create a statement with our new **Panorama Series Window**. "Designed with 30% more glass, the pivoting sash nests behind the window frame creating massive views and a clean, contemporary look. The 4" frame depth keeps the glass to the warm zone of the wall. Combine this with a triple weather seal and the result is better thermal performance than ever before. This series comes standard as a triple with 1 3/8" glazing or dual with 7/8" glazing which will meet all energy or thermal performance requirements. Built in casement, awning or picture windows, the Panorama Series is commonly used in modern or contemporary homes.

- 1. Triple weather seal
- 2. Fusion welded frame & sash
- 3. Contemporary design
- 4. Superior u-value
- 5. Triseal super spacer
- 6. Sash leveled with frame
- 7. Low profile design

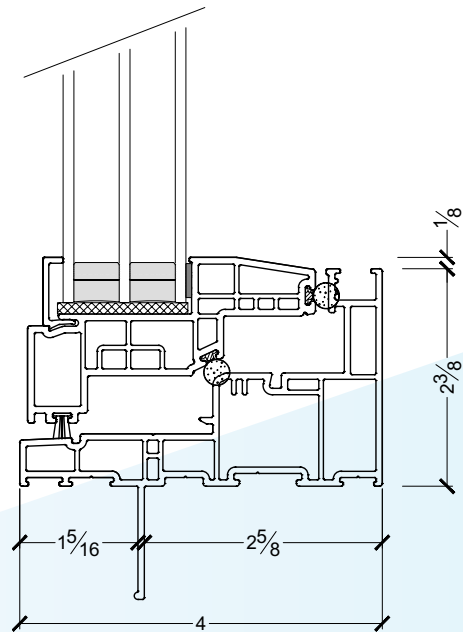

PERFORMANCE DATA

Picture window: Commercial
Classification. Performance Grade = PG 50

Casement window: Commercial
Classification. Performance Grade = PG 80

Awning window: Commercial
Classification. Performance Grade = PG 30

Style	U Value	SHGC	VT	Glazing Make Up	Performance
Awning	1.25	0.19	0.46	LoE-366 / LoE i-89	Good
Casement	1.19	0.19	0.46	LoE-366 / LoE i-89	Good
Picture	1.19	0.22	0.52	LoE-366 / LoE i-89	Good
Awning	0.91	0.18	0.41	LoE-366 / Clear / LoE-180	Better
Casement	0.91	0.18	0.41	LoE-366 / Clear / LoE-180	Better
Picture	0.85	0.20	0.47	LoE-366 / Clear / LoE-180	Better
Awning	0.85	0.17	0.40	LoE-366 / LoE-180 / LoE i-89	Best
Casement	0.85	0.17	0.40	LoE-366 / LoE-180 / LoE i-89	Best
Picture	0.74	0.19	0.45	LoE-366 / LoE-180 / LoE i-89	Best

OTHER GLAZING OPTIONS ARE AVAILABLE

UNLIMITED LIFETIME WARRANTY ON VINYL, GLASS AND HARDWARE. INCLUDING ALL PARTS, LABOUR AND CRAFTSMANSHIP. WARRANTIES ARE TRANSFERABLE TO NEW OWNERS FOR 25 YEARS.



7533 Progress Way, Delta, BC V4G 1E7
tel. 604.946.2310 toll free. 1.888.363.7832

2031 Malaview Ave W #105, Sidney, BC V8L 5X6
tel. 778.404.1695 Open by appointment only

westcoastwindows.ca

